

Apollo II





Check for updates

Apollo II

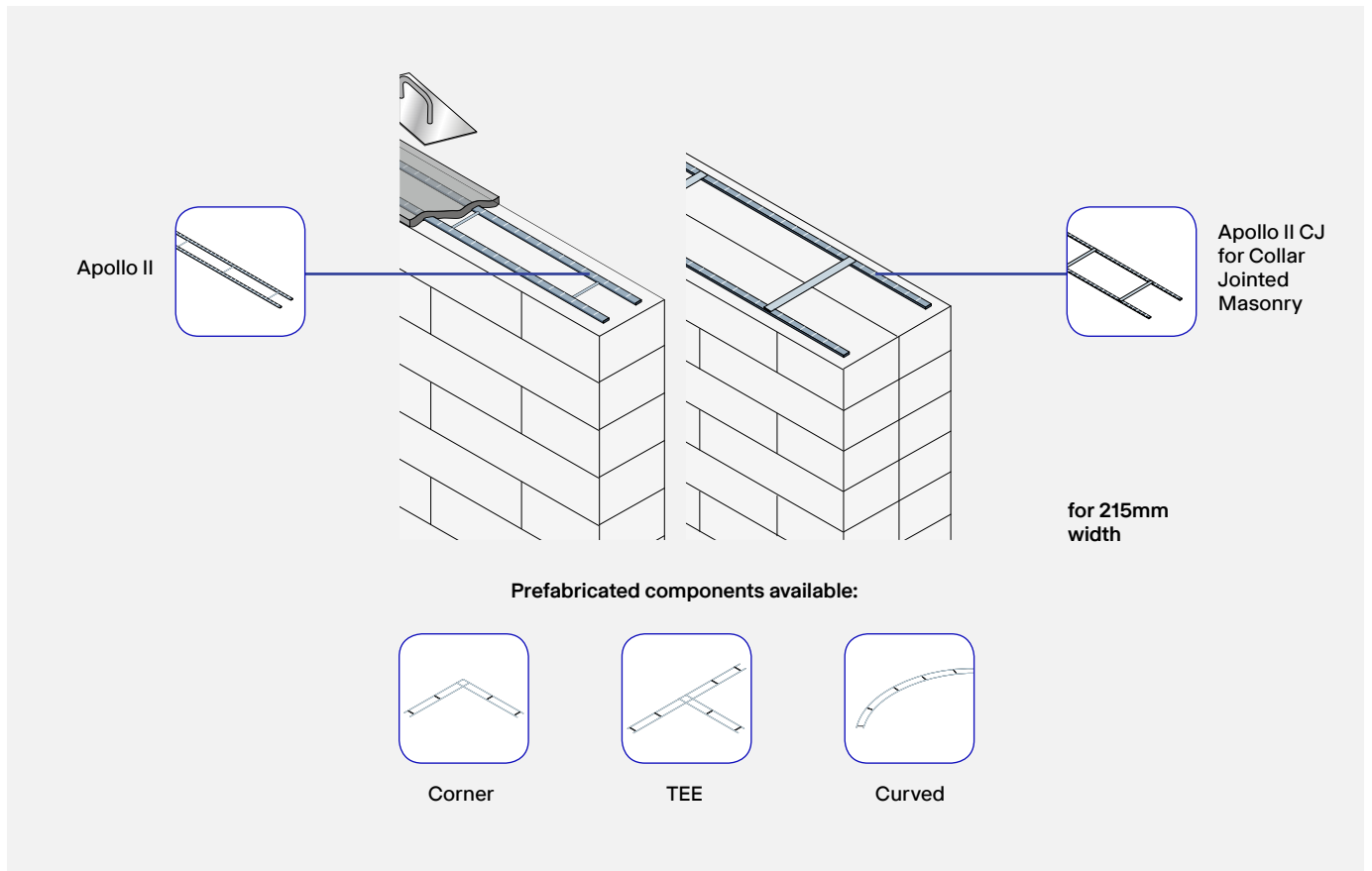

Apollo II masonry reinforcement

The use of masonry in building construction is a tried and trusted construction method used to create robust, durable and aesthetically appealing structures that last for 100's of years. Masonry – both clay bricks and concrete blocks, is a proven and versatile building material which is able to withstand very high compressive loads. However, in tension, where building loads can create deflection forces, masonry construction has span limitations and can be prone to cracking and failure if flexural strength is exceeded.

This is where reinforcing masonry can help. Apollo II is a masonry reinforcement (also termed 'bed joint' reinforcement) and is designed for use in structural masonry design applications to increase the flexural and tensile strength of masonry walls and façades in lateral and vertical load conditions. In addition, Apollo II is very useful in assisting the controlling of movement in masonry caused by shrinkage, stress and thermal expansion and contraction – so reducing the risk of cracking occurring in the masonry structure.

Apollo II



Check for updates

Advantages

Structural reliability

Reduced risk of cracking

Maximum anchorage

Through profiled main wires

Increased bond strength

Up to twice normal anchorage

Increased flexural and tensile strength

Unique flattened profile

Comprehensive range

Of widths and main wire sizes

CE marked

Certified and tested solution

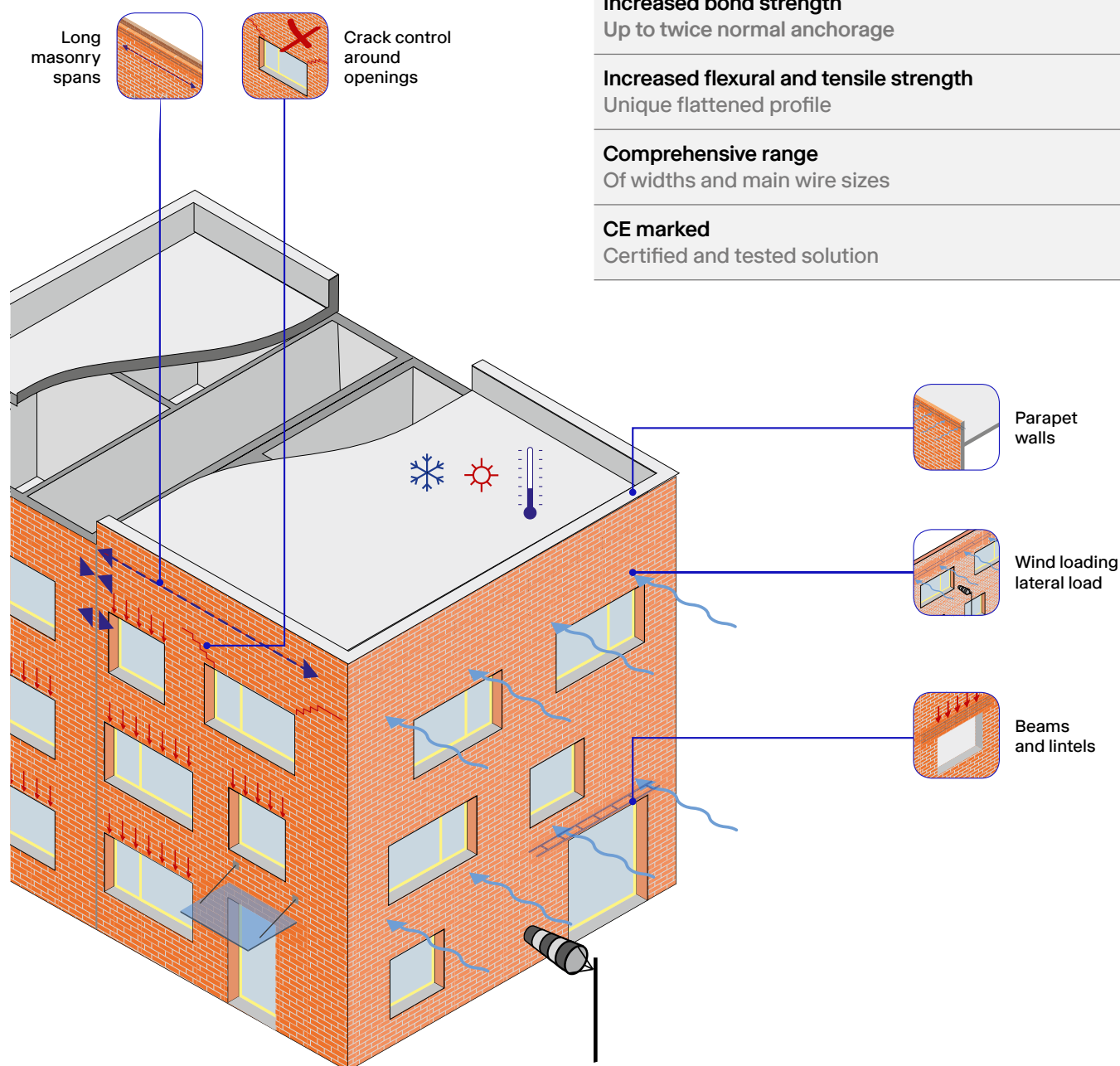

Apollo II



Check for updates

Apollo II

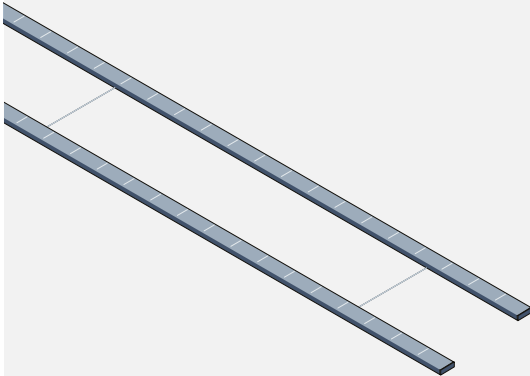

Apollo II materials

Stainless steel is suitable for use in most external applications (including MX2, MX3 & MX4 exposure classes) and offers maximum corrosion resistance and minimised future maintenance costs.

Apollo II CJ

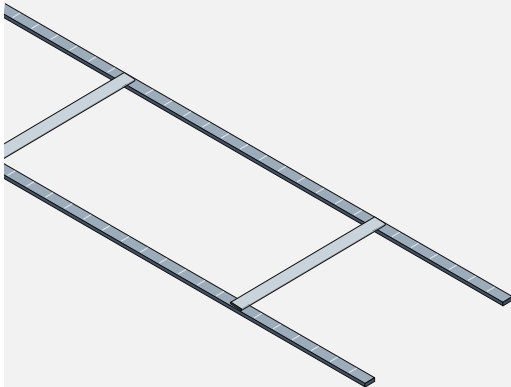

Apollo II



Check for updates

Apollo II structural applications

Wind loading

Apollo II is used to increase load capacity of façade walls and reduce the requirement for wind posts.

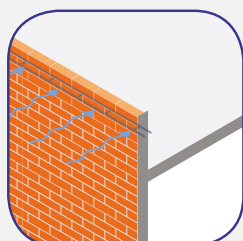

Parapets

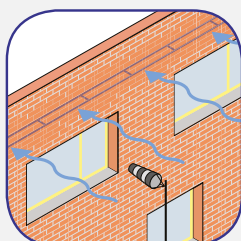

Wind loaded panels

Vertical loading

Apollo II is used to create reinforced masonry beams for lintels above openings.

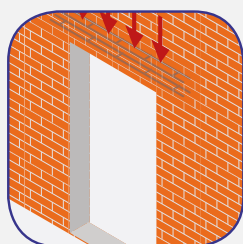
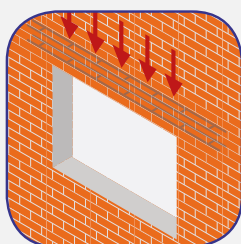
Masonry lintels
doors

Masonry lintels
windows

Apollo II



Check for updates

Apollo II movement control applications

Stress and shrinkage movement

Apollo II is used to reduce formation of cracks in masonry at vulnerable locations and due to shrinkage of materials.

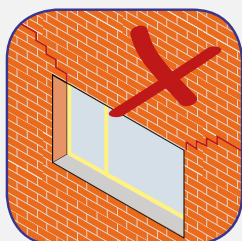

Stress cracking

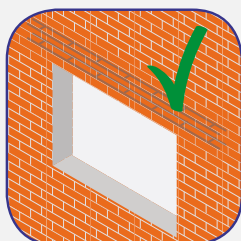

Avoid stress cracking

Thermal movement

Apollo II helps to control cracking in masonry caused by thermal movement. Distances between movement joints can be increased using Apollo II.

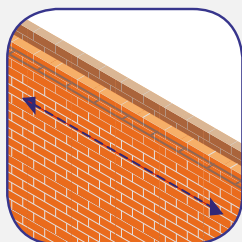

Masonry lintels
doors



Apollo II



Check for updates

Apollo II properties

Flattened profile with superior grip

Apollo II is manufactured from stainless steel creating unique, flattened and profiled main structural wires which help to improve bond performance compared with traditional smooth wires. The flattened profile allows for maximum coverage and anchorage within the 10 mm mortar joint, without compromising the cover within the joint.

Apollo II can provide scope for design optimisation, ultimately providing a cost-saving solution to the end-user.

Comprehensive range of widths and main wire sizes

Includes 3.0, 3.5, 4.0, 4.5 & 5.0 mm effective diameters for structural and crack-control applications.

In-line welded cross wires

Apollo II cross wires are welded in-line to avoid steel build up problems within the mortar joint in application. The cross-wire is sized at 2.75 mm diameter to help develop maximum anchorage with the profiled main wires within the mortar and creates a very robust and durable reinforcement strip.

Certification & product quality

Apollo II meets the requirement of BS EN845-3:2013 + A1:2016 - Specification for ancillary components for masonry. Bed joint reinforcement of steel mesh work.

CE Mark in accordance with clause 4:2:2 of the standard.

Declaration of Performance (DOP) documents available on request.

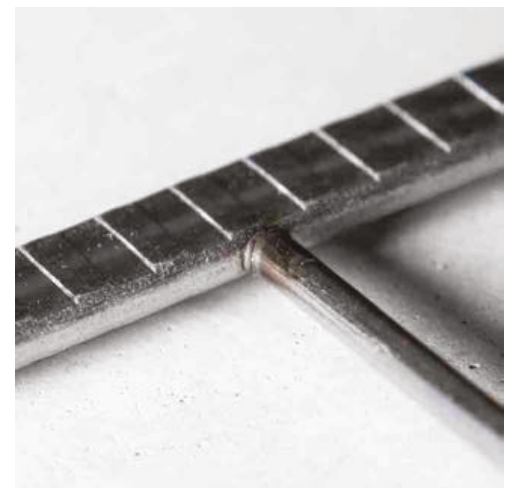
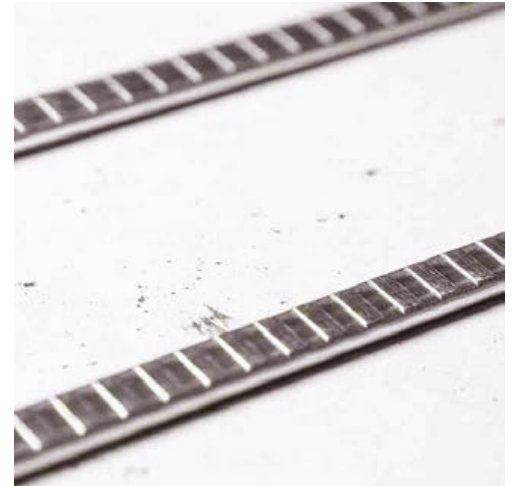

BS EN 845-3

Apollo II



Check for updates

| Item Code Exposure class ¹ MX2, MX3, (MX4) | Product width* w (mm) | Wall thickness d (mm) | Main Wire Nom ø (mm) |
|---|-----------------------------|-----------------------------|----------------------------|
| SLF30W060 | 60 | 102 brick or 100 block | 3 |
| SLF35W060 | 60 | 102 brick or 100 block | 3.5 |
| SLF40W060 | 60 | 102 brick or 100 block | 4 |
| SLF45W060 | 60 | 102 brick or 100 block | 4.5 |
| SLF50W060 | 60 | 102 brick or 100 block | 5 |
| SLF30W100 | 100 | 140 block | 3 |
| SLF35W100 | 100 | 140 block | 3.5 |
| SLF40W100 | 100 | 140 block | 4 |
| SLF45W100 | 100 | 140 block | 4.5 |
| SLF50W100 | 100 | 140 block | 5 |
| SLF30W150 | 150 | 190 or 200 block | 3 |
| SLF35W150 | 150 | 190 or 200 block | 3.5 |
| SLF40W150 | 150 | 190 or 200 block | 4 |
| SLF45W150 | 150 | 190 or 200 block | 4.5 |
| SLF50W150 | 150 | 190 or 200 block | 5 |
| SLF30W175 | 175 | 215 block | 3 |
| SLF35W175 | 175 | 215 block | 3.5 |
| SLF40W175 | 175 | 215 block | 4 |
| SLF45W175 | 175 | 215 block | 4.5 |
| SLF50W175 | 175 | 215 block | 5 |

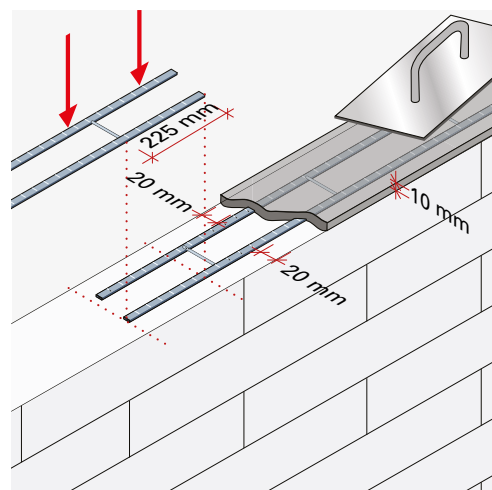
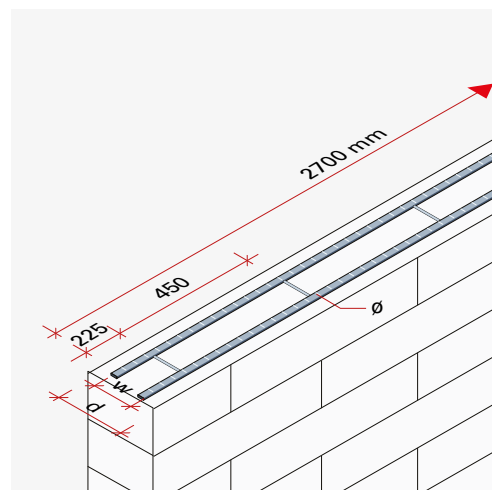

Units are strips – 2.70 m long with 20 strips in each pack = 54 m per pack
Minimum overlap is 225 mm

* Non standard product widths can be made to order

Apollo II



Check for updates

1) BS EN1996-2 Annex A . A1 - Classification of micro conditions of exposure of completed masonry

Class MX1 Masonry in a dry environment

Class MX2 Masonry exposed to moisture or wetting

Class MX3 Masonry exposed to moisture or wetting plus freeze thaw cycling

Class MX4** Masonry exposed to saturated salt air, sea water or de-icing salts

For MX4 conditions consult with ACS for advice

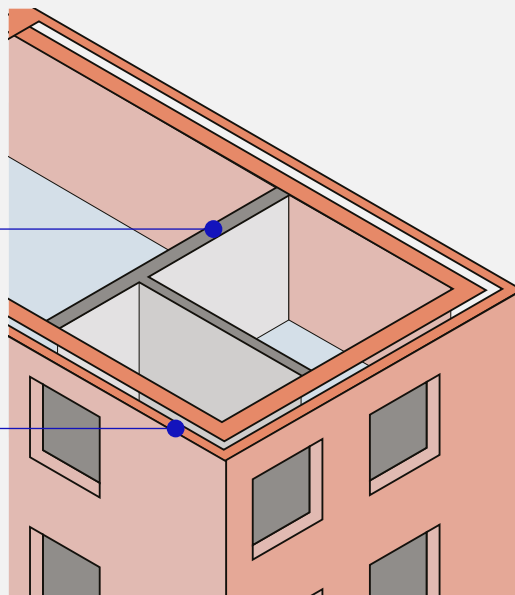



Check for updates

Apollo II

Apollo II CJ

Collar jointed masonry wall construction

Apollo II CJ combines Apollo II masonry reinforcement with a welded 20 mm x 3 mm cross tie to allow the construction of two leaves of masonry tied together. This alleviates the safety problems associated with the repeat lifting and placing of heavy 215 mm solid blocks.

Using Apollo II CJ it is possible to construct two leaves of 100 mm brick or block side by side, eliminating the heavy block situation and creating a so called 'Collar-Joint' built wall.

The Apollo II welded ties anchor across the two leaves, structurally tying them together, and the main reinforcing wires act to reinforce the wall against structural forces and/or to assist with movement control of the built wall panel.

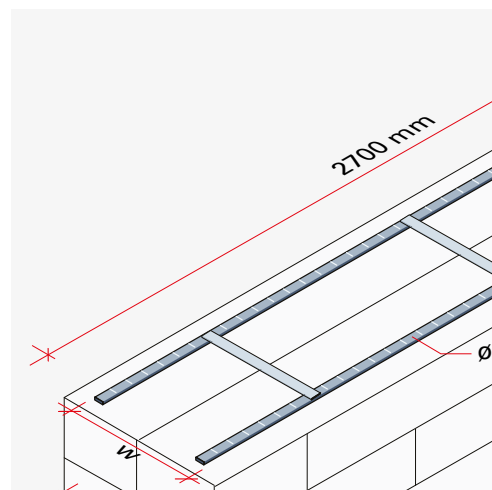

| Item Code Exposure class ¹ MX2, MX3, (MX4) | Product width* w (mm) | Wall thickness d (mm) | Main Wire Nom Ø (mm) |
|---|--------------------------|--------------------------|-------------------------|
| ATSCJ30 | 175 | 215 | 3 |
| ATSCJ35 | 175 | 215 | 3.5 |
| ATSCJ40 | 175 | 215 | 4 |
| ATSCJ45 | 175 | 215 | 4.5 |
| ATSCJ50 | 175 | 215 | 5 |



Check for updates

Apollo II

Apollo II Custom-Made

Custom-Made Apollo II

Apollo II can be custom-made in a variety of widths and shapes to assist with special details. The use of engineered units enables continuity of the full reinforcement to construct the detail or feature, so maintaining structural integrity of the masonry and providing crack control. From a site perspective, welded factory-made units reduce the need to fabricate on site and improve efficiency and build quality in conjunction with standard Apollo II reinforcement strips.

Within reason any shape can be fabricated. Corners and junctions, as well as radiused forms, are commonly called for.

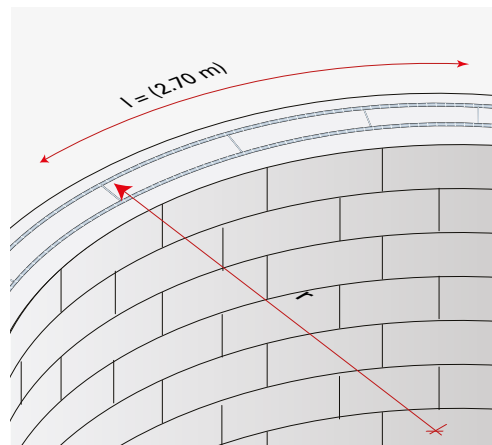

Apollo II



Check for updates

Apollo II Corner

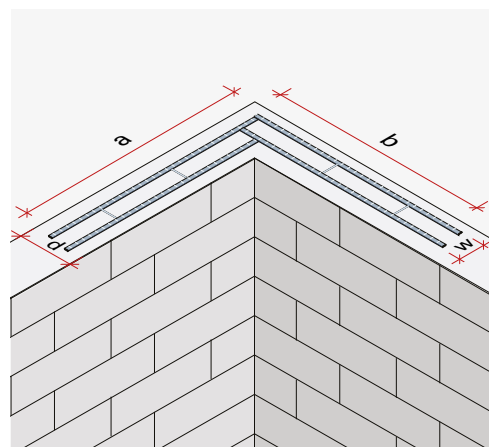

| Apollo II Corner Item Code | Main Wire Nom ø (mm) | Product width* w (mm) | Corner dimensions (a/b) (mm) | Wall thickness d (mm) |
|-------------------------------|-------------------------|--------------------------|---------------------------------|--------------------------|
| ATSC30W060 | 3 | 60 | 900 × 900 | 100 |
| ATSC40W060 | 4 | 60 | 900 × 900 | 100 |
| ATSC50W060 | 5 | 60 | 900 × 900 | 100 |
| ATSC30W100 | 3 | 100 | 900 × 900 | 140 |
| ATSC40W100 | 4 | 100 | 900 × 900 | 140 |
| ATSC50W100 | 5 | 100 | 900 × 900 | 140 |

Apollo II



Check for updates

Apollo II TEE

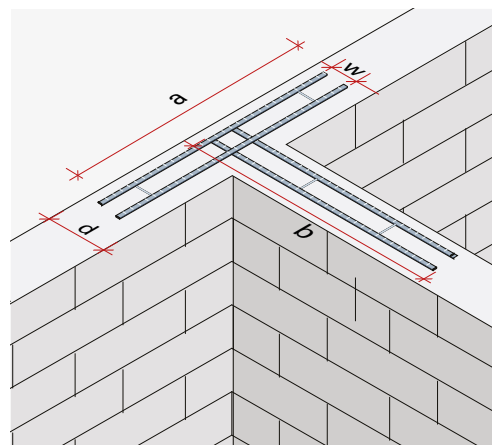

| Apollo II TEE Item Code | Main Wire Nom ø (mm) | Product width* w (mm) | TEE dimensions (a/b) (mm) | Wall thickness d (mm) |
|----------------------------|-------------------------|--------------------------|------------------------------|--------------------------|
| ATST30W060 | 3 | 60 | 900 × 900 | 100 |
| ATST40W060 | 4 | 60 | 900 × 900 | 100 |
| ATST50W060 | 5 | 60 | 900 × 900 | 100 |
| ATST30W100 | 3 | 100 | 900 × 900 | 140 |
| ATST40W100 | 4 | 100 | 900 × 900 | 140 |
| ATST50W100 | 5 | 100 | 900 × 900 | 140 |



Get in touch to learn more
about how ACS can help
you deliver your next project.

0113 391 8200
info@acsstainless.co.uk
acsstainless.co.uk

 ACS Stainless Steel Fixings Ltd
 ACSStainlessSteelFixings